

Revisions			
Rev	Description	Date	Initials
D	Next revision, updated from old database	10/1/2010	TPA
E	Changed Tolerances	10/11/2011	LG
F	Updated drawing to match actual mold features and dimension	3/26/2014	DVK

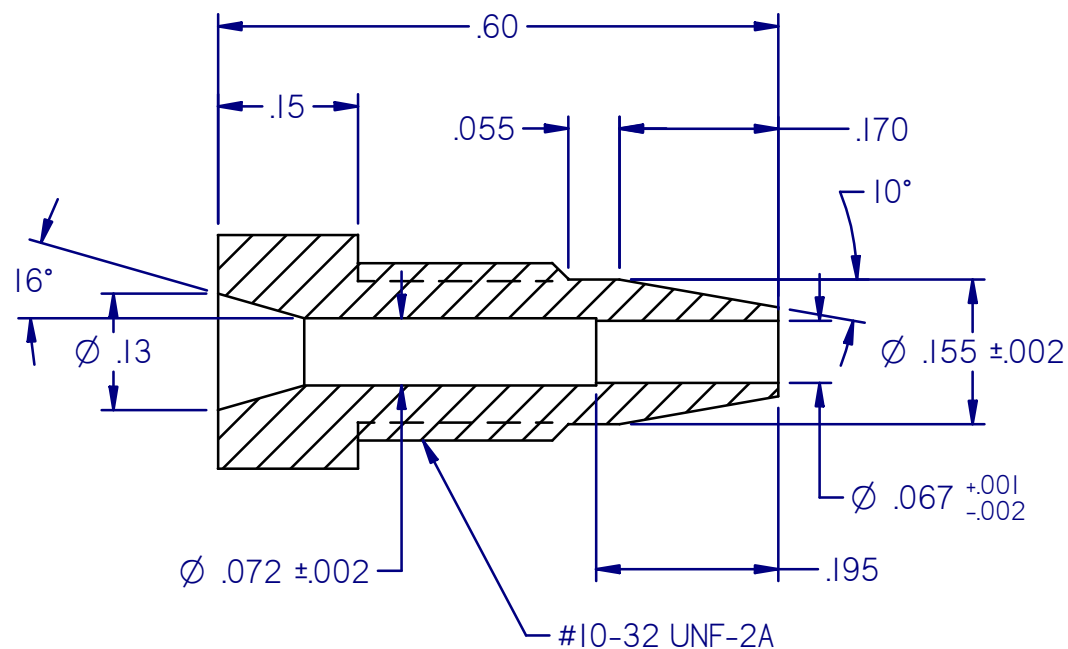

SECTION A-A

NOTES:

1. REMOVE ALL BURRS.
2. SURFACE FINISH AS MOLDED.
3. ALL RADII TO BE .031" MAX, UNLESS NOTED.
4. ALL DRAFT ANGLES TO BE 1° MAX, UNLESS NOTED.
5. USE THE SAME MOLD AS FOR DRAWING # 0000993 OR SAP# 2110665 OR ALLTECH # *32236.

CONFIDENTIAL:

This drawing is the property of Alltech Associates, Inc. Any reproductions or modifications of this drawing or its contents without consent of Alltech is prohibited.

GENERAL TOLERANCES
DECIMAL: XX ±.010"; XXX ±.005"
FRACTIONAL: ± 1/64"
ANGULAR: ±1/2°
UNLESS OTHERWISE SPECIFIED

GRACE Davison

GRACE Davison Discovery Sciences
2051 Waukegan Road, Deerfield, IL 60015
(847) 948-8600

DESCRIPTION: Shrt Hex Head One-Piece Ftnng

MATERIAL: 450CA30 PEEK

P/N: 2110680

DRAWN: DVK

APPROVED: SPS

DATE: 03/26/14

SCALE: 5 = 1
SIZE A

DRAWING NO: 0001213

REV
F

SHEET
1 OF 1